

GENEST

Block Shapes & Sizes



Introducing

G-MIX[®]

LOW CARBON CONCRETE



Available with up to 50% foamed recycled glass aggregate

50% LESS CEMENT & UP TO 55% RECYCLED MATERIAL WHILE EXCEEDING ASTM C90 SPECIFICATION REQUIREMENTS

Since 1985, Genest has been using less cement in concrete block production than most block producers, and now after years of experience and development, we are proud to introduce G-mix[®]. This formula uses up to 55% recycled aggregate and half of the cement traditionally used to produce concrete blocks. You can be confident that when you specify from Genest, you will have a low carbon footprint for your project.

The processing of cement, the primary binding agent in concrete, accounts for 75% of total carbon emissions by traditionally manufactured concrete. We offset the use of cement with slag, a byproduct from the steel industry, to reduce our carbon footprint. The materials we use to supplement cement have the added benefit of increasing strength and efficiency, improving color, and decreasing efflorescence.

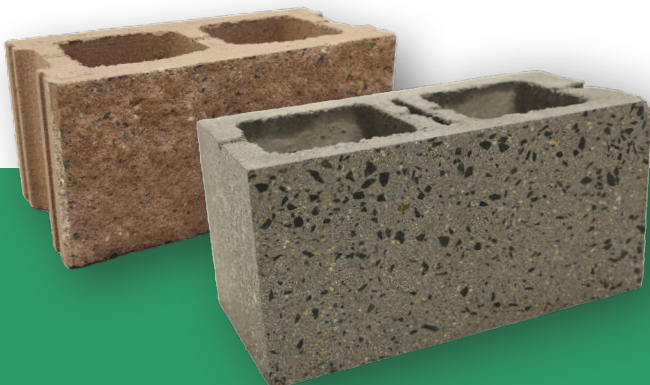

G-MIX NORMAL WEIGHT ENVIRONMENTAL PRODUCT DECLARATION (EPD) DATA

Global Warming Potential (kg CO ₂ -eq):	129
Acidification Potential (kg SO ₂ -eq):	0.65
Eutrophication Potential (kg N-eq):	0.16
Smog Creation Potential (kg O ₃ -eq):	12.9
Ozone Depletion Potential (kg CFC-11-eq):	5.99E-6

- ✓ **50% Less Cement**
- ✓ **Up to 55% Recycled Materials**
- ✓ **Exceeds Strength Requirements**
- ✓ **Third-Party Tested**
- ✓ **Locally Sourced Aggregate**
- ✓ **Low Carbon Footprint**

Normal Weight Option:

G-mix® 5% recycled content

Lightweight Options:

G-mix®25 25% recycled content

G-mix®45 45% recycled content

G-mix®55 55% recycled content

The use of slag in our concrete formula results in greater cement reduction than typical CO₂ curing methods without compromising strength and durability. Our Environmental Product Declarations (EPDs), available at ASTM.org, show that the environmental impact of G-mix® is among the lowest in the industry. **The carbon footprint of our normal-weight architectural CMUs is over 65% lower than the industry average.***

COMPARISON OF CONCRETE MASONRY UNIT GLOBAL WARMING POTENTIAL

*based on the Carbon Leadership Forum's 2021 Material Baseline Report

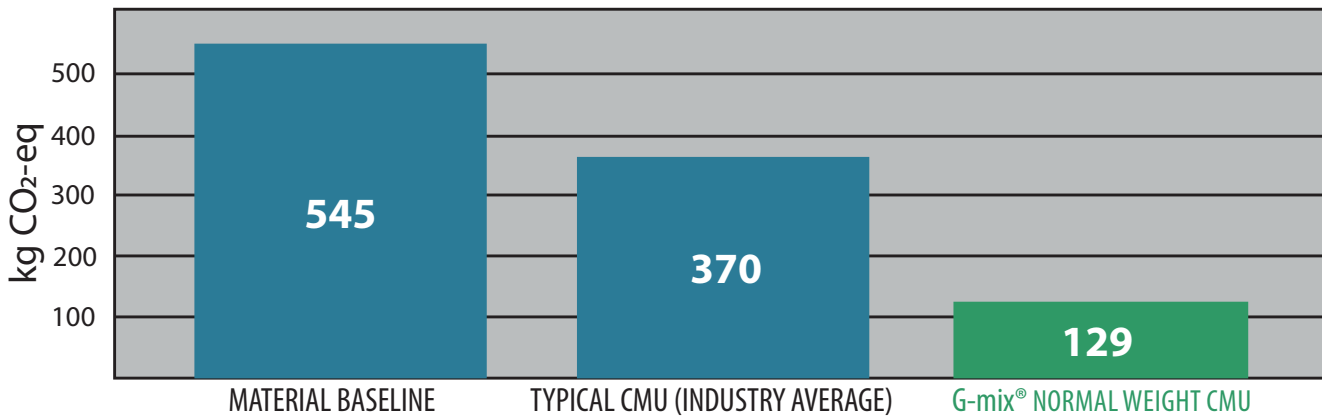

To further reduce our environmental impact, we have the ability to replace over 50% of the aggregate in our blocks with foamed recycled glass. In addition to reducing waste and the extraction of raw materials, this improves thermal efficiency and results in up to 25% weight reduction, producing a lighter weight block that still exceeds strength requirements. Lighter weight blocks significantly lower transportation costs and reduce carbon emissions associated with transport.



When you specify from Genest, you are making an environmentally responsible choice while ensuring that your project will continue to perform as designed for years to come. Contact us today for specification details!

G-mix was developed using proven methods of CO₂ reduction with quantifiable, verifiable results. The cradle-to-gate environmental impact of G-mix® has been third-party tested and ASTM-verified.

Our Environmental Product Declarations (EPDs), published by ASTM, provide detailed information regarding the environmental impact of our extraction, transport, and manufacturing processes.





Genest architectural block is available in a wide variety of colors and finishes. Ask your Genest representative for a sample kit before making your final selection.

Architectural specifications, product guides, color and finish options, and other resources are available to download at genestconcrete.com.

To assist with designing and planning, Revit and SketchUp files for our Comfort Block systems are available at CADdetails.com.



Four Inch Block Shapes

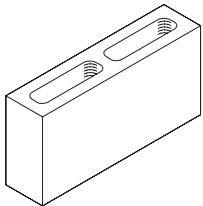

Stretcher
3⁵/₈" x 7⁵/₈" x 15⁵/₈"

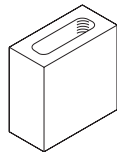

Half
3⁵/₈" x 7⁵/₈" x 7⁵/₈"

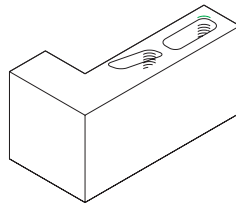

L-Corner
3⁵/₈" x 7⁵/₈" x 15⁵/₈"

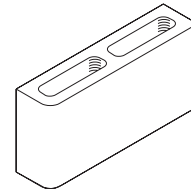

Single Bullnose
3⁵/₈" x 7⁵/₈" x 15⁵/₈"

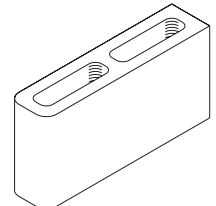

Double Bullnose
3⁵/₈" x 7⁵/₈" x 15⁵/₈"

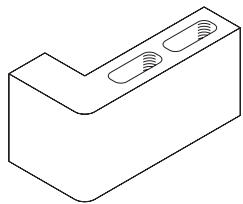

Single Bullnose L-Corner
3⁵/₈" x 7⁵/₈" x 15⁵/₈"

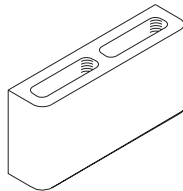

Double Bullnose Face
3⁵/₈" x 7⁵/₈" x 15⁵/₈"

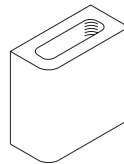

Single Bullnose Half
3⁵/₈" x 7⁵/₈" x 7⁵/₈"

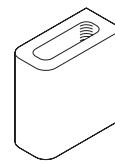

Double Bullnose Half
5⁵/₈" x 7⁵/₈" x 7⁵/₈"

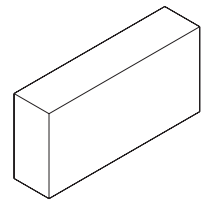

4" Solid
3⁵/₈" x 7⁵/₈" x 15⁵/₈"

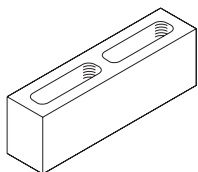

Starter
3⁵/₈" x 4⁵/₈" x 15⁵/₈"

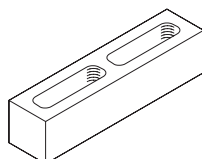

Half High
3⁵/₈" x 3⁵/₈" x 15⁵/₈"

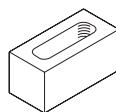

Half High Half
3⁵/₈" x 3⁵/₈" x 7⁵/₈"

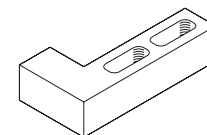

Half High L-Corner
3⁵/₈" x 3⁵/₈" x 15⁵/₈"

Manchester Block®

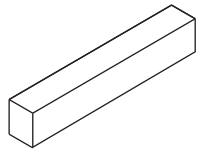

3⁵/₈" x 3⁵/₈" x 23⁵/₈"

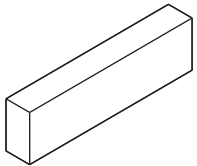

3⁵/₈" x 7⁵/₈" x 23⁵/₈"

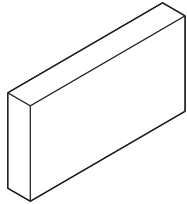

3⁵/₈" x 11⁵/₈" x 23⁵/₈"

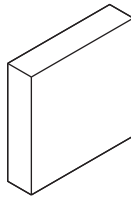

3⁵/₈" x 15⁵/₈" x 15⁵/₈"

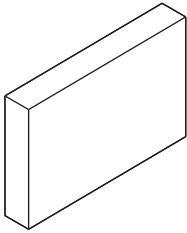

3⁵/₈" x 15⁵/₈" x 23⁵/₈"

Six Inch Block Shapes

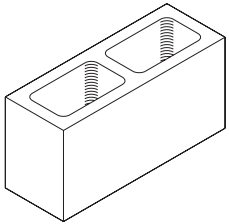

Stretcher
5⁵/₈" x 7⁵/₈" x 15⁵/₈"

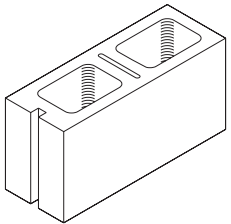

Combo
5⁵/₈" x 7⁵/₈" x 15⁵/₈"

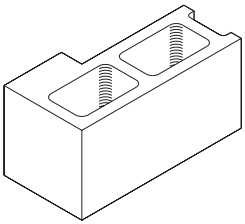

L-Corner
5⁵/₈" x 7⁵/₈" x 15⁵/₈"

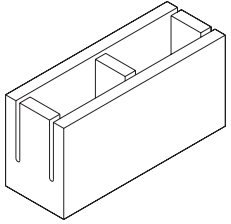

Bond Beam Knock Out
5⁵/₈" x 7⁵/₈" x 15⁵/₈"

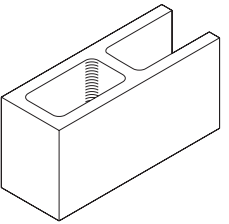

A-Block
5⁵/₈" x 7⁵/₈" x 15⁵/₈"

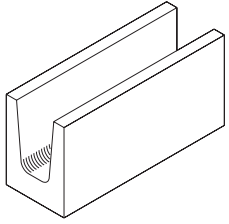

Bond Beam Solid
5⁵/₈" x 7⁵/₈" x 15⁵/₈"

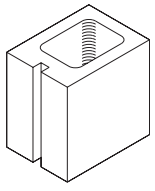

Half
5⁵/₈" x 7⁵/₈" x 7⁵/₈"

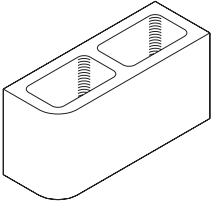

Single Bullnose
5⁵/₈" x 7⁵/₈" x 15⁵/₈"

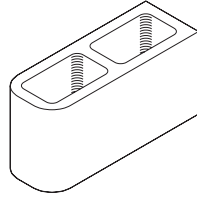

Double Bullnose
5⁵/₈" x 7⁵/₈" x 15⁵/₈"

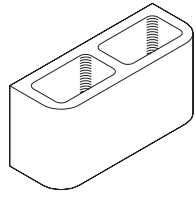

Double Bullnose Face
5⁵/₈" x 7⁵/₈" x 15⁵/₈"

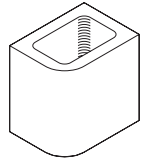

Single Bullnose Half
5⁵/₈" x 7⁵/₈" x 7⁵/₈"

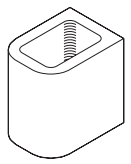

Double Bullnose Half
5⁵/₈" x 7⁵/₈" x 7⁵/₈"

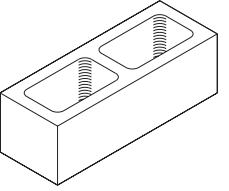

Starter
5⁵/₈" x 4⁵/₈" x 15⁵/₈"

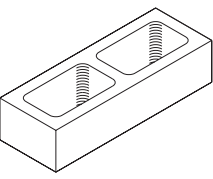

Half High
5⁵/₈" x 3⁵/₈" x 15⁵/₈"

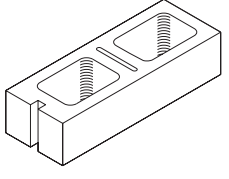

Half High Combo
5⁵/₈" x 3⁵/₈" x 15⁵/₈"

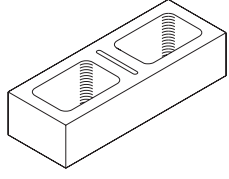

Half High Pier Combo
5⁵/₈" x 3⁵/₈" x 15⁵/₈"

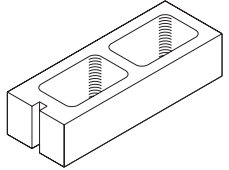

Half High Full Sash
5⁵/₈" x 3⁵/₈" x 15⁵/₈"

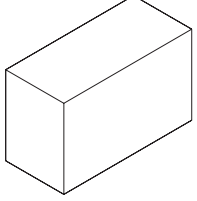

6" Solid
5⁵/₈" x 7⁵/₈" x 15⁵/₈"

Eight Inch Block Shapes

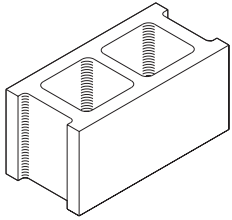

Stretcher
7⁵/₈" x 7⁵/₈" x 15⁵/₈"

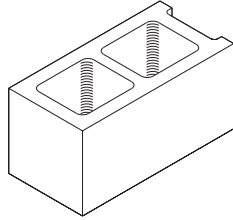

Corner
9⁵/₈" x 7⁵/₈" x 15⁵/₈"

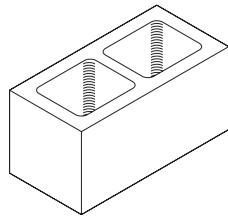

Pier
7⁵/₈" x 7⁵/₈" x 15⁵/₈"

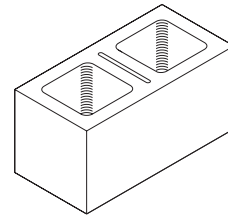

Pier Combo
7⁵/₈" x 7⁵/₈" x 15⁵/₈"

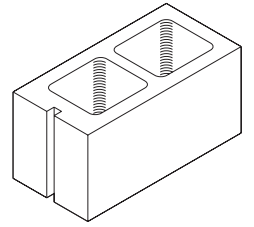

Full Sash
7⁵/₈" x 7⁵/₈" x 15⁵/₈"

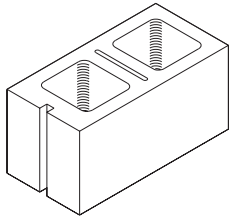

Combo
7⁵/₈" x 7⁵/₈" x 15⁵/₈"

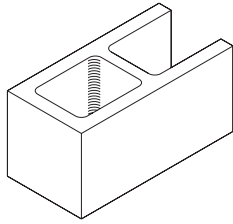

A-Block
7⁵/₈" x 7⁵/₈" x 15⁵/₈"

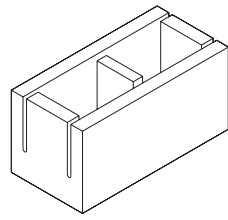

Bond Beam Knock Out
7⁵/₈" x 7⁵/₈" x 15⁵/₈"

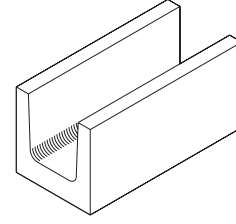

Bond Beam Solid
7⁵/₈" x 7⁵/₈" x 15⁵/₈"

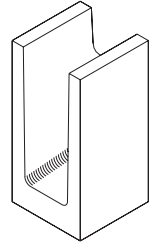

Beam Lintel
7⁵/₈" x 15⁵/₈" x 7⁵/₈"

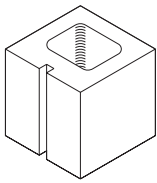

Half
7⁵/₈" x 7⁵/₈" x 7⁵/₈"

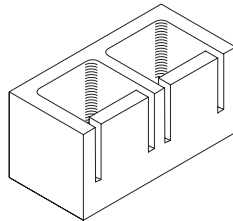

Grout Block
7⁵/₈" x 7⁵/₈" x 15⁵/₈"

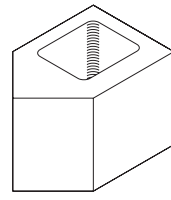

Splay Block
7⁵/₈" x 7⁵/₈" x 7⁵/₈"

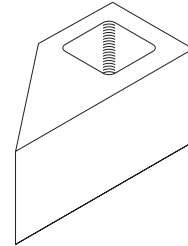

45 Degree Outside Corner
7⁵/₈" x 7⁵/₈" x 7⁵/₈" x 15⁵/₈"

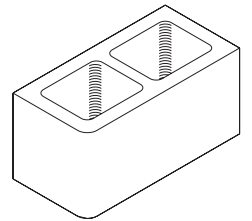

Single Bullnose
7⁵/₈" x 7⁵/₈" x 15⁵/₈"

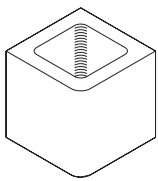

Single Bullnose Half
7⁵/₈" x 7⁵/₈" x 7⁵/₈"

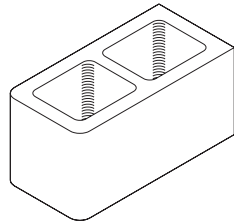

Double Bullnose
7⁵/₈" x 7⁵/₈" x 15⁵/₈"

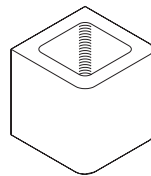

Double Bullnose Half
7⁵/₈" x 7⁵/₈" x 7⁵/₈"

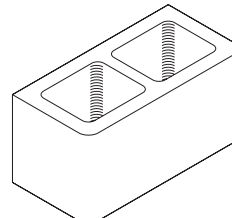

Double Bullnose Face
7⁵/₈" x 7⁵/₈" x 15⁵/₈"

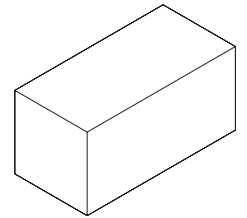

8" Solid
7⁵/₈" x 7⁵/₈" x 15⁵/₈"

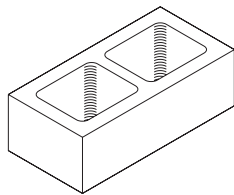

Starter
7⁵/₈" x 4⁵/₈" x 15⁵/₈"

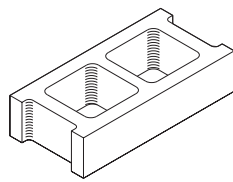

Half High
7⁵/₈" x 3⁵/₈" x 15⁵/₈"

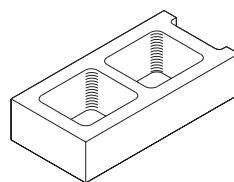

Half High Corner
7⁵/₈" x 3⁵/₈" x 15⁵/₈"

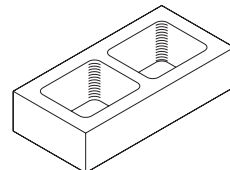

Half High Pier
7⁵/₈" x 3⁵/₈" x 15⁵/₈"

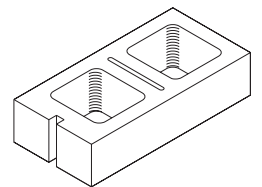

Half High Combo
7⁵/₈" x 3⁵/₈" x 15⁵/₈"



FULLY INSULATED
R-19
END BLOCKS
ALSO AVAILABLE

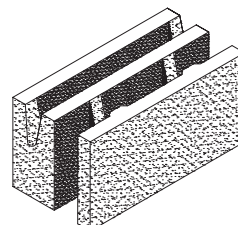

8" Omni Block
7⁵/₈" x 7⁵/₈" x 15⁵/₈"

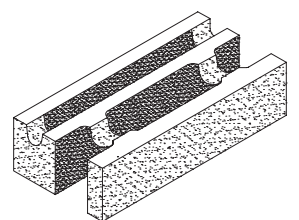

8" Omni Brick
7⁵/₈" x 3⁵/₈" x 15⁵/₈"

Chimney Block Shapes

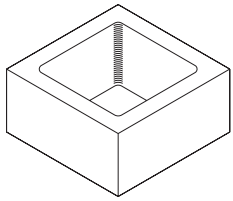

Chimney Full
8" x 8"

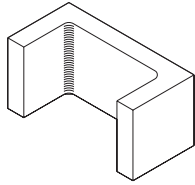

Chimney Half
8" x 8"

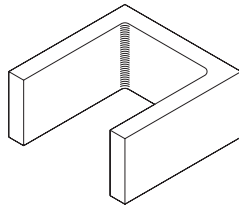

Adapter
8" x 8"

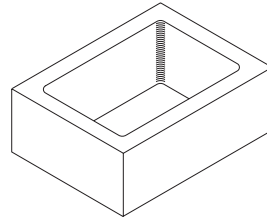

Chimney Full
8" x 12"

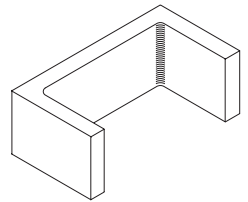

Chimney Half
12" x 12"

Ten Inch Block Shapes

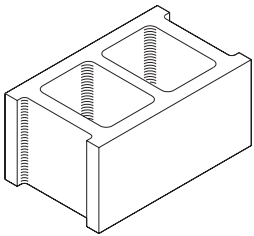

Stretcher
9⁵/₈" x 7⁵/₈" x 15⁵/₈"

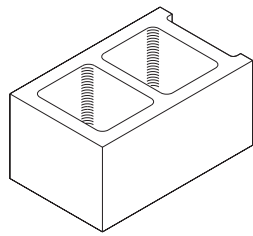

Corner
9⁵/₈" x 7⁵/₈" x 15⁵/₈"

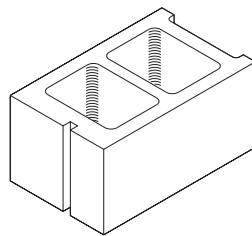

Full Sash
9⁵/₈" x 7⁵/₈" x 15⁵/₈"

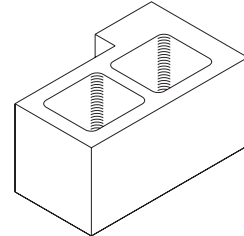

L-Corner
9⁵/₈" x 7⁵/₈" x 15⁵/₈"

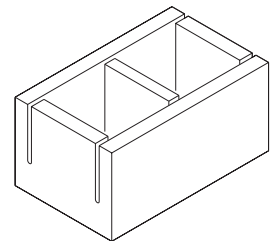

Bond Beam Knock Out
9⁵/₈" x 7⁵/₈" x 15⁵/₈"

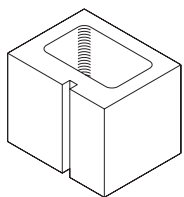

Half
9⁵/₈" x 7⁵/₈" x 7⁵/₈"

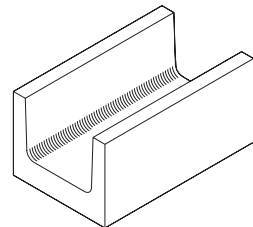

Bond Beam Solid
9⁵/₈" x 7⁵/₈" x 15⁵/₈"

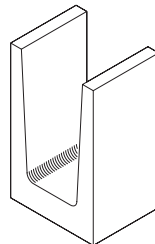

Beam Lintel
9⁵/₈" x 15⁵/₈" x 7⁵/₈"

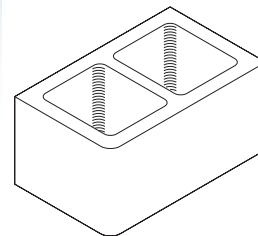

Single Bullnose
9⁵/₈" x 7⁵/₈" x 15⁵/₈"

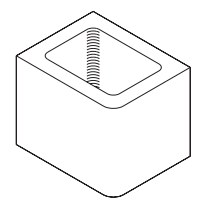

Single Bullnose Half
9⁵/₈" x 7⁵/₈" x 7⁵/₈"

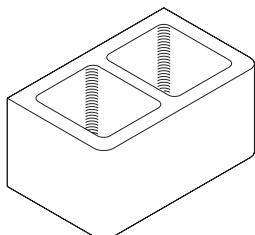

Double Bullnose
9⁵/₈" x 7⁵/₈" x 15⁵/₈"

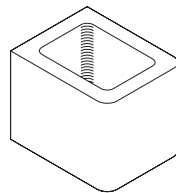

Double Bullnose Half
9⁵/₈" x 7⁵/₈" x 7⁵/₈"

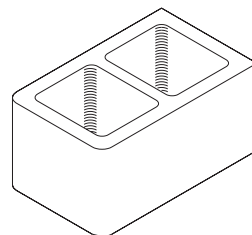

Double Bullnose Face
9⁵/₈" x 7⁵/₈" x 15⁵/₈"

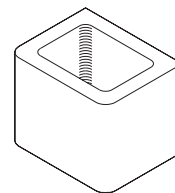

Double Bull Half Face
9⁵/₈" x 7⁵/₈" x 7⁵/₈"

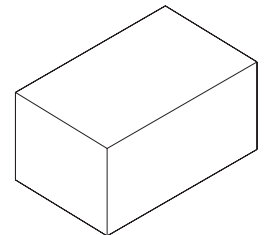

12" Solid
9⁵/₈" x 7⁵/₈" x 15⁵/₈"

Twelve Inch Block Shapes

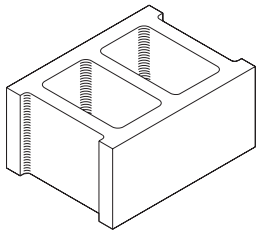

Stretcher
11⁵/₈" x 7⁵/₈" x 15⁵/₈"

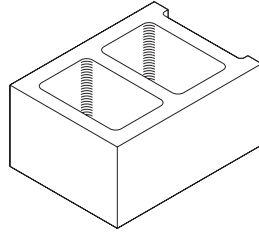

Corner
11⁵/₈" x 7⁵/₈" x 15⁵/₈"

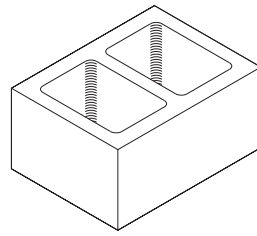

Pier
11⁵/₈" x 7⁵/₈" x 15⁵/₈"

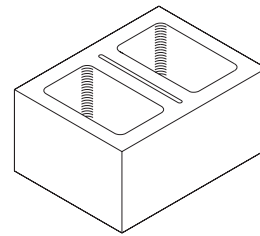

Pier Combo
11⁵/₈" x 7⁵/₈" x 15⁵/₈"

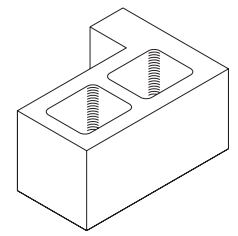

L-Corner
11⁵/₈" x 7⁵/₈" x 15⁵/₈"

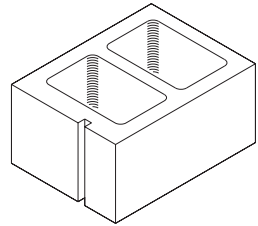

Full Sash
11⁵/₈" x 7⁵/₈" x 15⁵/₈"

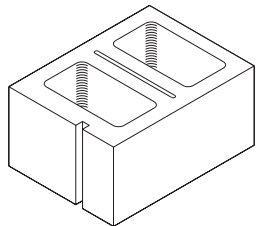

Combo
11⁵/₈" x 7⁵/₈" x 15⁵/₈"

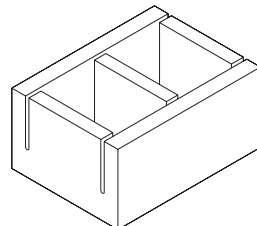

Bond Beam Knock Out
11⁵/₈" x 7⁵/₈" x 15⁵/₈"

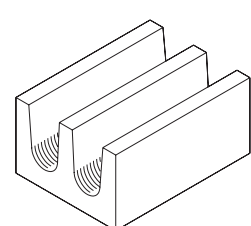

Solid Bottom Bond Beam
11⁵/₈" x 7⁵/₈" x 15⁵/₈"

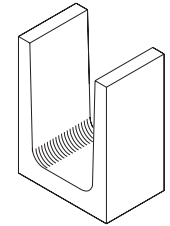

Beam Lintel
11⁵/₈" x 15⁵/₈" x 7⁵/₈"

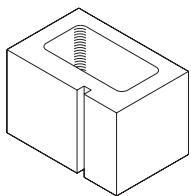

Half
11⁵/₈" x 7⁵/₈" x 7⁵/₈"

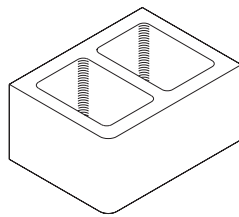

Starter
11⁵/₈" x 4⁵/₈" x 15⁵/₈"

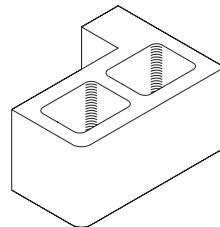

Single Bull L-Corner
11⁵/₈" x 7⁵/₈" x 15⁵/₈"

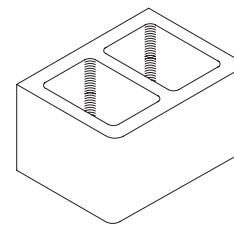

Single Bullnose
11⁵/₈" x 7⁵/₈" x 15⁵/₈"

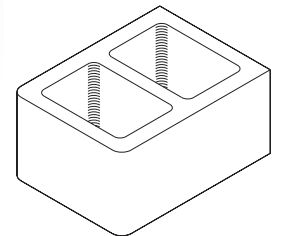

Double Bullnose
11⁵/₈" x 7⁵/₈" x 15⁵/₈"

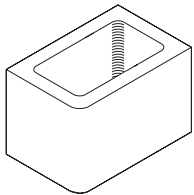

Double Bullnose Face
11⁵/₈" x 7⁵/₈" x 15⁵/₈"

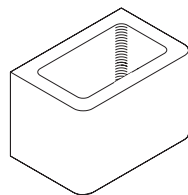

Single Bullnose Half
11⁵/₈" x 7⁵/₈" x 7⁵/₈"

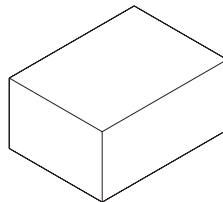

Double Bullnose Half
11⁵/₈" x 7⁵/₈" x 15⁵/₈"

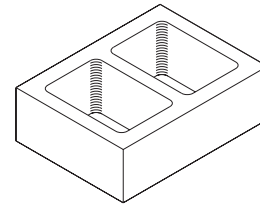

12" Solid
11⁵/₈" x 7⁵/₈" x 15⁵/₈"

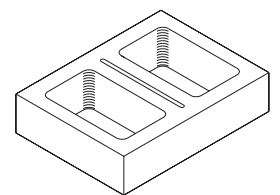

Half Pier Combo
11⁵/₈" x 3⁵/₈" x 15⁵/₈"

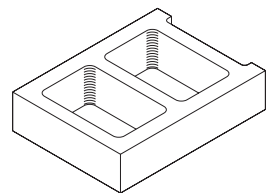

Half High Corner
11⁵/₈" x 3⁵/₈" x 15⁵/₈"

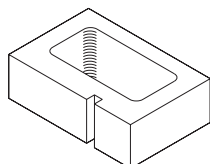

Half High Half
11⁵/₈" x 3⁵/₈" x 7⁵/₈"

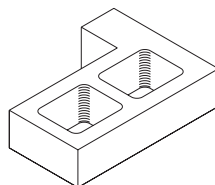

Half High L-Corner
11⁵/₈" x 3⁵/₈" x 15⁵/₈"

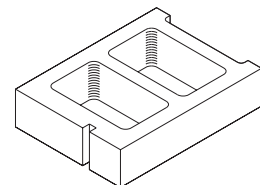

Half High Full Sash
11⁵/₈" x 3⁵/₈" x 15⁵/₈"

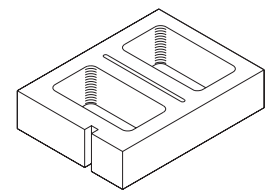

Half High Combo
11⁵/₈" x 3⁵/₈" x 15⁵/₈"



FULLY INSULATED
R-29
END BLOCKS
ALSO AVAILABLE

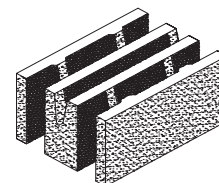

12" Omni Block
11 5/8" x 7 5/8" x 15 5/8"

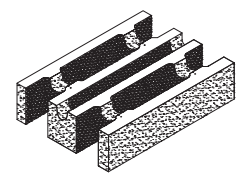

12" Omni Brick
11 5/8" x 3 5/8" x 15 5/8"

Sill Block

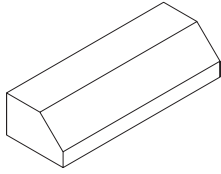

Custom sill blocks are available. A diagram is required for fabrication. Please inquire for more information at 800-649-4773.

Standard Half-High Easy Brick®

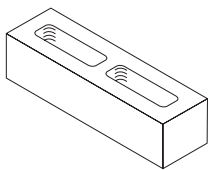

$3\frac{5}{8}'' \times 3\frac{5}{8}'' \times 15\frac{5}{8}''$

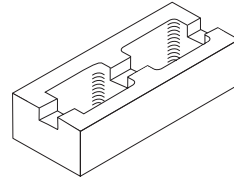
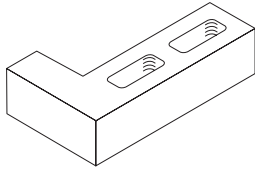

$7\frac{5}{8}'' \times 3\frac{5}{8}'' \times 15\frac{5}{8}''$

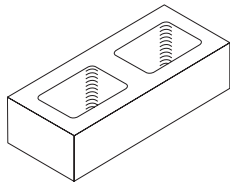
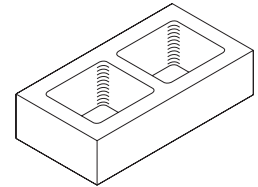

$5\frac{5}{8}'' \times 3\frac{5}{8}'' \times 15\frac{5}{8}''$

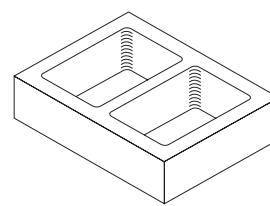
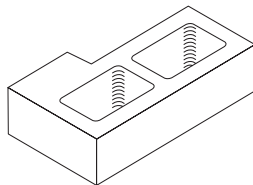

$11\frac{5}{8}'' \times 3\frac{5}{8}'' \times 15\frac{5}{8}''$

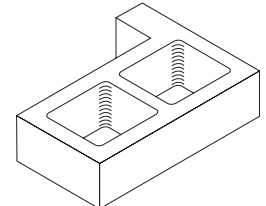

Genest Architectural Brick

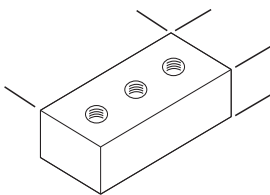

Stretcher
 $3\frac{5}{8}'' \times 2\frac{1}{4}'' \times 7\frac{5}{8}''$

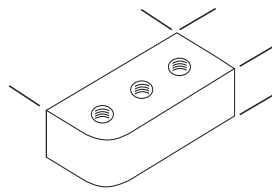

Single Bullnose

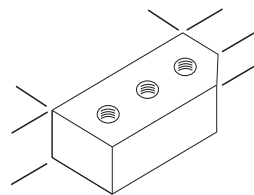

45° / Sill Corner

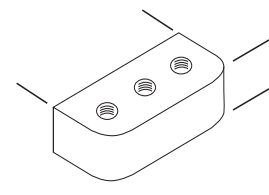

Double Bullnose

Solid Block Shapes

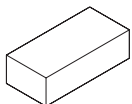

Concrete Brick
 $2\frac{1}{4}'' \times 3\frac{5}{8}'' \times 7\frac{5}{8}''$

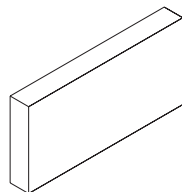

Soap
 $1\frac{5}{8}'' \times 7\frac{5}{8}'' \times 15\frac{5}{8}''$

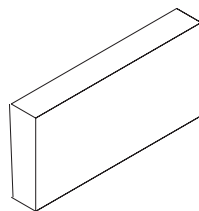

Patio
 $2'' \times 7\frac{5}{8}'' \times 15\frac{5}{8}''$

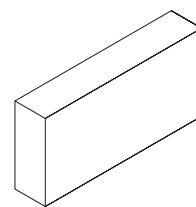

3" Solid
 $2\frac{5}{8}'' \times 7\frac{5}{8}'' \times 15\frac{5}{8}''$

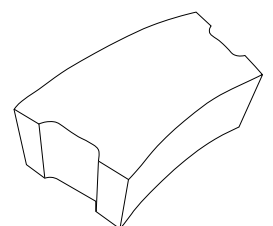

Barrel Block
 $7\frac{5}{8}'' \times 5\frac{5}{8}'' \times 15\frac{5}{8}''$



COMFORT BLOCK®

A NEW GENERATION OF BUILDING SYSTEMS

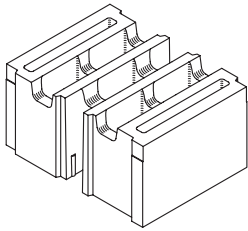

CB-16 Stretcher
16"x8"x12"

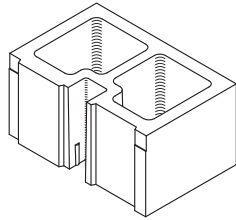

CB-16 Corner
16"x8"x10"

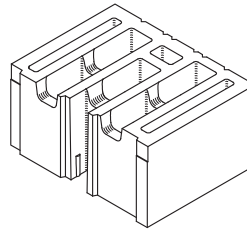

CB-16 Full Jamb
16"x8"x12"

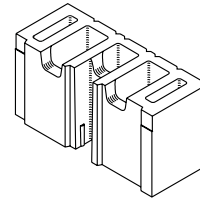

CB-16 Half Jamb
16"x8"x6"

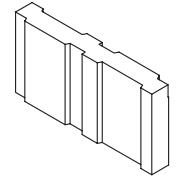

CB-16 Spacer
16"x8"x2"

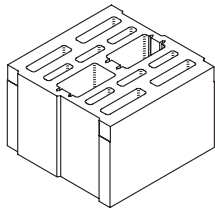

CB-12 Stretcher
12"x8"x12"

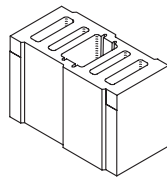

CB-12 Half
12"x8"x6"

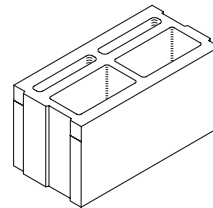

CB-8 Stretcher
8"x8"x16"

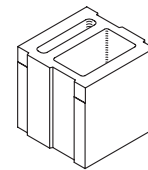

CB-8 Half
8"x8"x8"

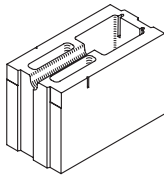

CB-6 Stretcher
6"x8"x12"

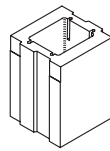

CB-6 Half
6"x8"x6"

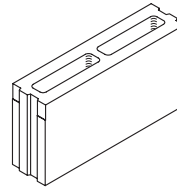

CB-4 Stretcher
4"x8"x16"

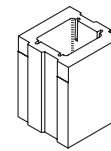

CB-4 Half
4"x8"x8"

To assist with designing and planning, Revit and SketchUp files for all Comfort Block systems can be downloaded for free at CADdetails.com.



PRECISION GROUND CONCRETE WALL SYSTEM

Homes
Buildings
Landscaping





Safe. Strong. Smart.®

Building with Comfort Block® is much easier and faster than traditional masonry construction. Precision engineering allows our blocks to be assembled using only adhesive, eliminating the need for mortar. An integrated electrical channel makes it easy to install the electrical system after construction.

Quickly and easily construct durable homes, buildings, landscaping features, and more with less waste of materials.

Comfort Block® is made with G-mix® so you can be confident that you will have a low-carbon footprint for your project.



EASILY ASSEMBLED WITH MASONRY ADHESIVE



SOUND-REDUCING AND AIRTIGHT TO CREATE THE IDEAL INDOOR ENVIRONMENT



120+ MPH WIND RESISTANCE FOR PROTECTION FROM SEVERE WEATHER



ULTRA EFFICIENT — SAVE UP TO 75% IN HEATING & COOLING COSTS



RESISTS MOLD, MILDEW, AND PESTS TO KEEP YOUR BUILDING'S INTERIOR CLEAN AND HEALTHY



CB-16 SYSTEM IS 16" THICK WITH THREE LAYERS OF INTEGRATED INSULATION FOR SUPERIOR TEMPERATURE STABILITY

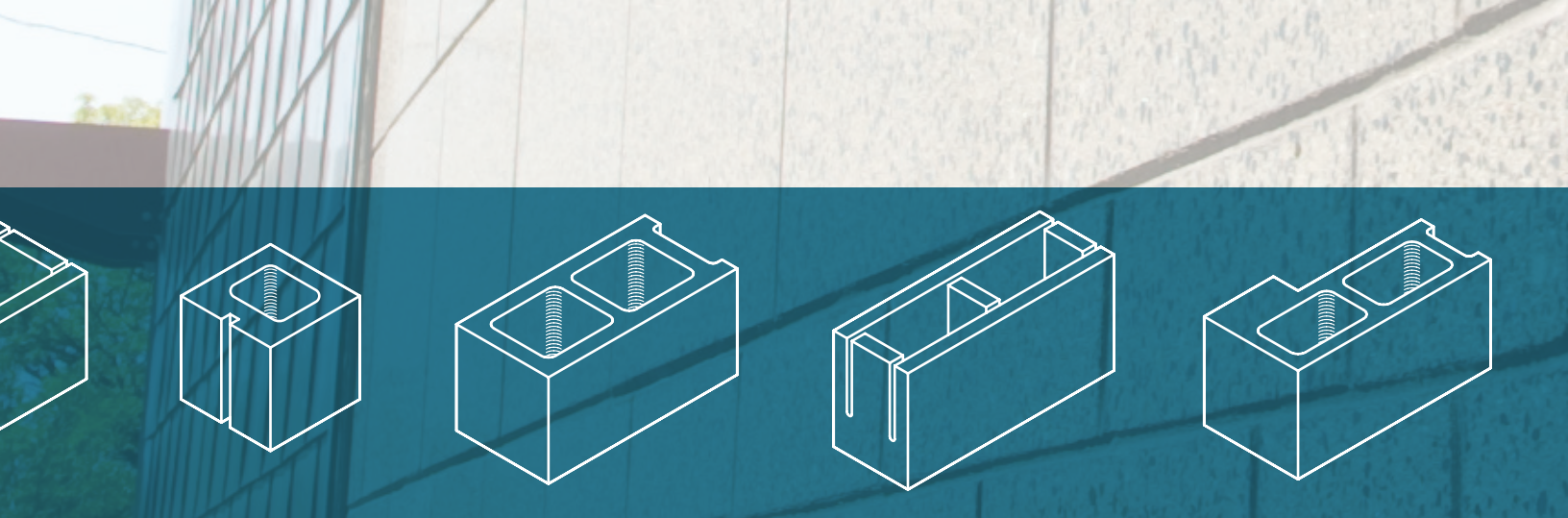

Genest has been manufacturing concrete products in southern Maine since 1927. We use Maine materials and Maine labor to make products that meet or exceed the highest industry standards. We are proud to manufacture our products in Maine, and we think you'll be proud to have them in your next project.

Genest is committed to practicing sustainable manufacturing. We have made it our mission to reduce the environmental impact of concrete construction through innovative engineering, the use of reclaimed and recycled materials as well as locally sourced aggregate, and monitoring of fossil fuels used during the manufacturing process. Our products are subject to ongoing, continual improvement as we continually challenge our materials and processes, pushing the boundaries of what a concrete block can be.



WWW.GENESTCONCRETE.COM

   GENESTCONCRETE

1-800-649-4773